

Introduction to Computing in SCS

Presenter

Brie Carranza

Assistant Technical Manager, Help Desk

Agenda

Welcome!

About SCS Computing

The (Computing) Environment

Your SCS Account

End-User Computing

SCS Computing Resources

Security

Review

Conclusion

Welcome! **Getting Help**

SCS Computing Facilities

CMU Computing Services

Building and Office Management

Ask the SCS Help Desk if you are not sure who to contact.

Welcome! SCS Computing Facilities

4th Floor Gates

SCS Help Desk

help@cs.cmu.edu

412-268-4231 or x8-4231

Gates Hillman Room 4203

<http://cs.cmu.edu/~help>



Welcome! CMU Computing Services

CMU Help Center

it-help@cmu.edu

412-268-4357 or x8-4357

Cyert Hall Room 119

<http://cmu.edu/computing>

Andrew accounts, Andrew printing,
public clusters, wireless
networking

5th Floor Gates

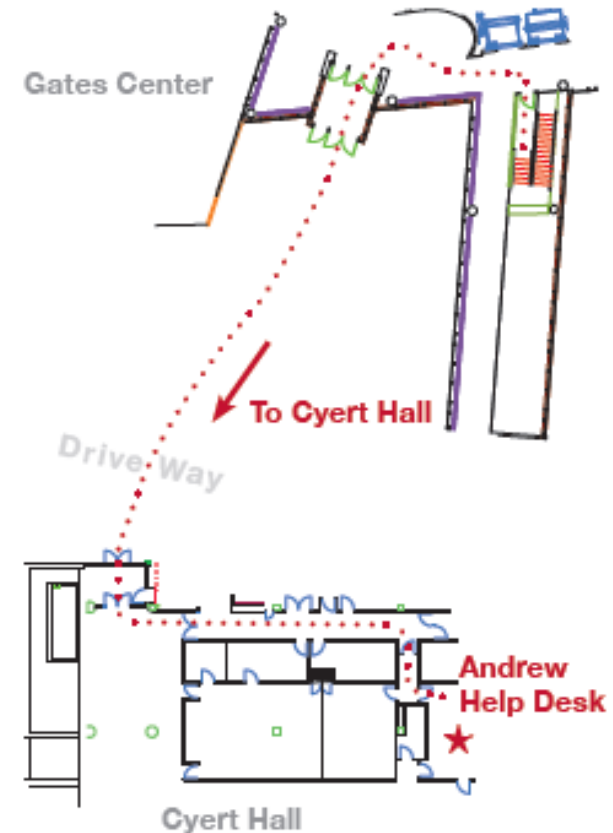

Welcome! **Building and Office Management**

How to contact

GHC 4103

Jim Skees – skees@cs.cmu.edu

Paul Stockhausen and Jamie Gregory

Off-Hours Building Emergencies:

Campus Police – 412-268-2323

What they can help with

Furniture

Keys

ID Card Access to SCS Buildings

Telephone

Ergonomic issues

Agenda

Welcome!

About SCS Computing

The (Computing) Environment

Your SCS Account

End-User Computing

SCS Computing Resources

Security

Review

Conclusion

About SCS Computing **What We Do**

SCS Help Desk

Printing

Hardware Repair

Software Licensing

Software Support

Networking (wired)

Technical Purchasing

Asset Management

Email

Archival Backups and Data
Protection

...anything else related to SCS
Computing

About SCS Computing Help Us
Help You

When reporting
problems to
help@cs.cmu.edu,
please include:

Your name, SCS username and
preferred contact method

Computer location and hostname or
asset tag

Description of problem with error
messages

About SCS Computing **System Security**

Clauss Strauch

- May contact you directly
- Responsible for system security

Information Security Office (ISO)

- May contact you directly

Agenda

Welcome!

About SCS Computing

The (Computing) Environment

Your SCS Account

End-User Computing

SCS Computing Resources

Security

Review

Conclusion

The Environment **Acceptable Use**

Reasonable Person Principle

Keep your password private

Respect others' privacy

The Environment **Accounts and Passwords**

SCS Account – username@cs.cmu.edu

Andrew Account – username@andrew.cmu.edu

Your username should be the same through all Carnegie Mellon computing environments.

There are many passwords to keep track of!

The Environment **Web Login**

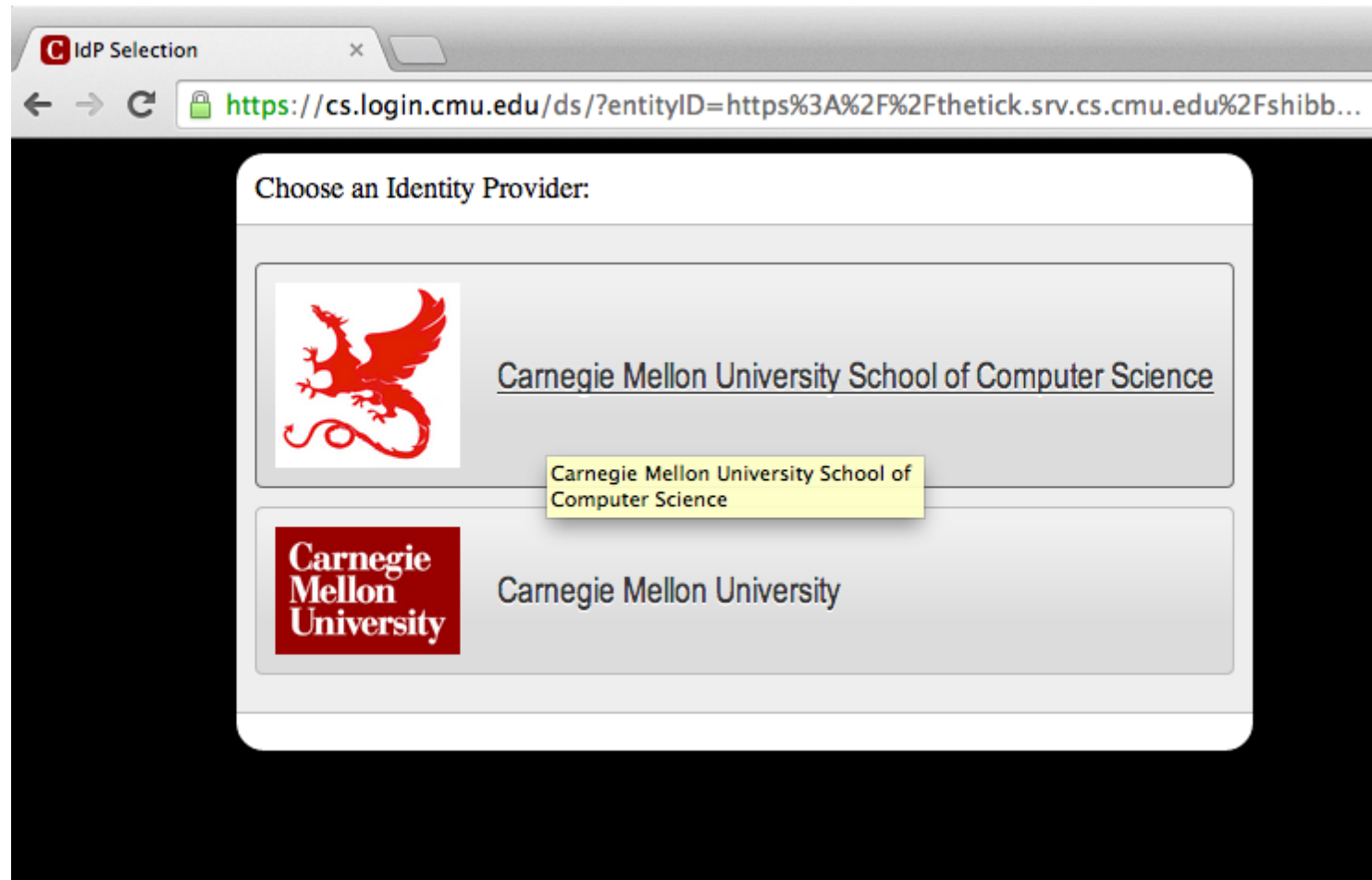

The Environment **Common SCS Passwords**

Kerberos – Main SCS Password

- Used for SCS web authentication
- Used for accessing AFS and logging in to SCS Linux machines

Windows Password

- Used for logging in to SCS Windows machines
- Used for accessing SCS printing, software shares on monolith

The Environment **Common SCS Passwords**

/mail – SCS Email Password

- Used with an email client (Thunderbird, Outlook, mobile devices)
- May be used with webmail

/remote – SCS VPN and iPass

- May be used while working off-campus or on the wireless network
- Helps with printing to SCS printers, accessing SCS software
- Travelling (iPass)

The Environment **Common SCS Passwords**

Kerberos – Main SCS Password

/mail – SCS Email Password



WebISO Secure Login

The resource you requested requires you to authenticate.

User ID:

Password:

Instance

None

/mail

The Environment **Manage your SCS Passwords**

Use the Instance Manager to change SCS passwords

<https://webiso.cs.cmu.edu/instance>

Most passwords can be reset without knowing the old one.

The Environment **Logging In**

Windows

- Use your SCS Windows password – SCS\username

OS X

- Use the local password specific to this machine

Ubuntu

- Use your SCS Kerberos password

Agenda

Welcome!

About SCS Computing

The (Computing) Environment

Your SCS Account

End-User Computing

SCS Computing Resources

Security

Review

Conclusion

Your SCS Account **Email**

username@cs.cmu.edu - and some others

Hosted here

/mail instance for access

- Supported email clients (Thunderbird, Outlook, Mail.app, Alpine, etc.)
- Mobile devices

Webmail – webmail.cs.cmu.edu

Out of Office

Your SCS Account **Email**

Forwarded

- What happens when you try to log in to webmail
- Greylisting and email delays (sending to self, Google)
- Send email as (Google)

Your SCS Account **Email Management**

How to update forwarding

Spam settings

The above are changes you can make online

Be cautious with attachments, spear phishing

Your SCS Account **Personal Web Page**

`http://cs.cmu.edu/~username`

Can be hosted in your AFS space or redirected to an existing site

Setup info at in welcome email

Agenda

Welcome!

About SCS Computing

The (Computing) Environment

Your SCS Account

End-User Computing

SCS Computing Resources

Security

Review

Conclusion

End-User Computing **Your SCS Computer**

You are an administrator; be careful

Feel free to customize the software but know that we will only re-image the machine

Do not change the IP address

UPS stays with the office, we will replace batteries, repair the UPS

- If it starts beeping let us know right away

End-User Computing **Your SCS Computer**

Your SCS computer is Carnegie Mellon property

- Do not give it away or sell it

Let the SCS Help Desk know right away if it's lost or stolen

Do not leave computer unattended in public places

End-User Computing **Hardware Support**

On your SCS-provided computer

- If it breaks, we will fix it
- Do not change the IP address
- Do not move your computer; let us move it for you

End-User Computing **Archival Backups**

Do not turn your computer off overnight – this is when backups run

We perform restores for you

You'll be notified if backups fail, we'll work with you to get them working again

VMs and certain special files won't be backed up

Backup Status Dashboard

End-User Computing **Data Protection**

Data is synced regularly

You can restore via the web to the same computer or a different one

250 GB rolling quota

Data will be synced from any network, not just on campus

Backup Status Dashboard

End-User Computing **Operating Systems**

We support and deploy these operating systems:

- Windows 7
- Mac OS X 10.9.x (Mavericks)
- Ubuntu 14.04 LTS

End-User Computing **System Configurations**

	Password	Where to get software	Administrator?
Windows	SCS Windows	pc_dist share on monolith	Yes
OS X	(Local account)	Self Service	Yes
Ubuntu	Main Kerberos	apt-get	Yes

End-User Computing **Virtual Machines**

Pre-installed VMs are supported like a desktop

Backups for VMs are separate from the host machine

VMs have their own IP address that you can use

End-User Computing **Printing Setup**

	Add Printer	Password	
Windows	SCS Windows	SCS Windows	
OS X	Self Service App Store	SCS Windows	

End-User Computing **Available Printers**

List of printers available

Public printers

Special options like duplex and high volume are available.

Use color only when necessary

Print large jobs during off-hours

End-User Computing **File Storage and Sharing**

AFS

Andrew File System

`/afs/cs.cmu.edu/user/username`

Default: 1 GB Quota

OldFiles – Nightly backup of your AFS space

Storage for `~username` website

End-User Computing **File Storage and Sharing**

ACL management

- Default ACL - modify with care
- ACLs can be used to grant access to others

How to access?

Academic volumes

Other AFS cells – Andrew, ECE, Qatar

End-User Computing **Box**

50 GB quota

Securely share with other students, professors, people outside CMU

Mobile apps

Desktop clients

See Computing Services

Authenticate with Andrew ID

Agenda

Welcome!

About SCS Computing

The (Computing) Environment

Your SCS Account

End-User Computing

SCS Computing Resources

Security

Review

Conclusion

SCS Computing Resources **VPN**

How to get software

Requires /remote password

SCS has two VPNs, Andrew has one

SCS Computing Resources **Networking**

SCS wired network

Outlet Activation

Personal machines can connect – additional setup required

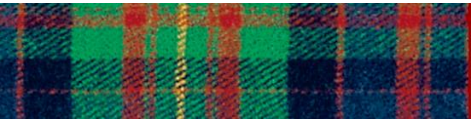

SCS Computing Resources **Printing**

Public printers

List of printers

Authentication (Windows, Mac, Linux, personally owned) – refer to
~help

Tip: Connect to the SCS VPN before printing from the wireless network or off-campus!

SCS Computing Resources **Software**

Where to get it and how to log in?

- pc_dist
- Self Service
- Apt-get
- CMU List (LSL)
- DreamSpark

Eligibility (and Length of Usage)

SCS Computing Resources **Software**

Licensed Software List – <http://www.cmu.edu/software/all/index.html>

Personal Windows Laptop

- Pc_dist for Office and Symantec

Personal Mac Laptop

- Mac_dist for Office and Symantec?

SCS Computing Resources **Matlab**

Your department provided computer – under software support so we can provide it, comes with toolboxes

Windows – See SCS Help Desk for DVD

Mac – Self Service

Linux – `sudo apt-get install matlab`

Matlab for personal computers

See Computing Services – Licensed Software List

SCS Computing Resources **General Access Computing**

General purpose Linux computer

Server Name: **linux.gp.cs.cmu.edu**

Use your main Kerberos password

Used for:

- AFS access
- Updating your ~username website

Supports SSH, SCP and SFTP

Specify the destination you want to connect to

Host Name (or IP address)	Port
<input type="text" value="example@linux.gp.cs.cmu.edu"/>	<input type="text" value="22"/>

Connection type:

Raw Telnet Rlogin SSH Serial

Load, save or delete a stored session

Saved Sessions

<input type="text" value="example@linux.gp.cs.cmu.edu"/>	
<input type="text" value="Default Settings example@linux.gp.cs.cmu.edu"/>	<input type="button" value="Load"/>
	<input type="button" value="Save"/>

Agenda

Welcome!

About SCS Computing

The (Computing) Environment

Your SCS Account

End-User Computing

SCS Computing Resources

Security

Review

Conclusion

Security **Physical Security**

Remember physical security!

Please don't leave your computer unattended in public places!

SCS Computing Resources **Security**

Password Management

Passwords should be unique

- Keys to the kingdom
- Some applications will force this
- Use strong, random passwords

Resetting passwords

Agenda

Welcome!

About SCS Computing

The (Computing) Environment

Your SCS Account

End-User Computing

SCS Computing Resources

Security

Review

Conclusion

Review **Next Steps**

- Get logged in
 - Change your passwords from the temporary password
- Set up your SCS email
- Publish your <http://cs.cmu.edu/~username>
- Read the Introduction to SCS Computing Guide
- Visit the SCS Help Desk with any questions

Conclusion

Any questions?

Thank you!